

PROFILE LAKE  
ADA-ACCESSIBLE TRAIL DESIGN

February 6, 2017

Located at :  
Profile Lake; Franconia Notch  
FRANCONIA, NEW HAMPSHIRE

PREPARED FOR:

Northern New England Field Services  
71 Piper Hill Road  
Stewartstown, NH 03576

OWNER:

State of New Hampshire  
Department of Resources  
& Economic Development  
172 Pembrok Road  
Concord, NH 03301

ENGINEER:

Right Angle Engineering, PLLC  
Erin Darrow, P.E., C.P.E.S.C.  
152 Main Street  
New London, NH 03257  
(603) 526-2807 office  
(603) 443-7815 mobile  
(603) 523-8811 fax  
Ern@RightAngle.Engineering

SURVEYOR:

York Land Services, LLC  
Burke York, L.L.S.  
3 Twelfth Street  
Berlin, NH 03570  
(603) 752-7282  
bylls@myfairpoint.net

WETLAND SCIENTIST:

Beaver Tracks, LLC  
Jonathan Sisson, C.W.S., C.S.S.  
21 Hale Hill Road  
Swanzey, NH 03445  
(603) 313-4925  
beavertracksllc@yahoo.com

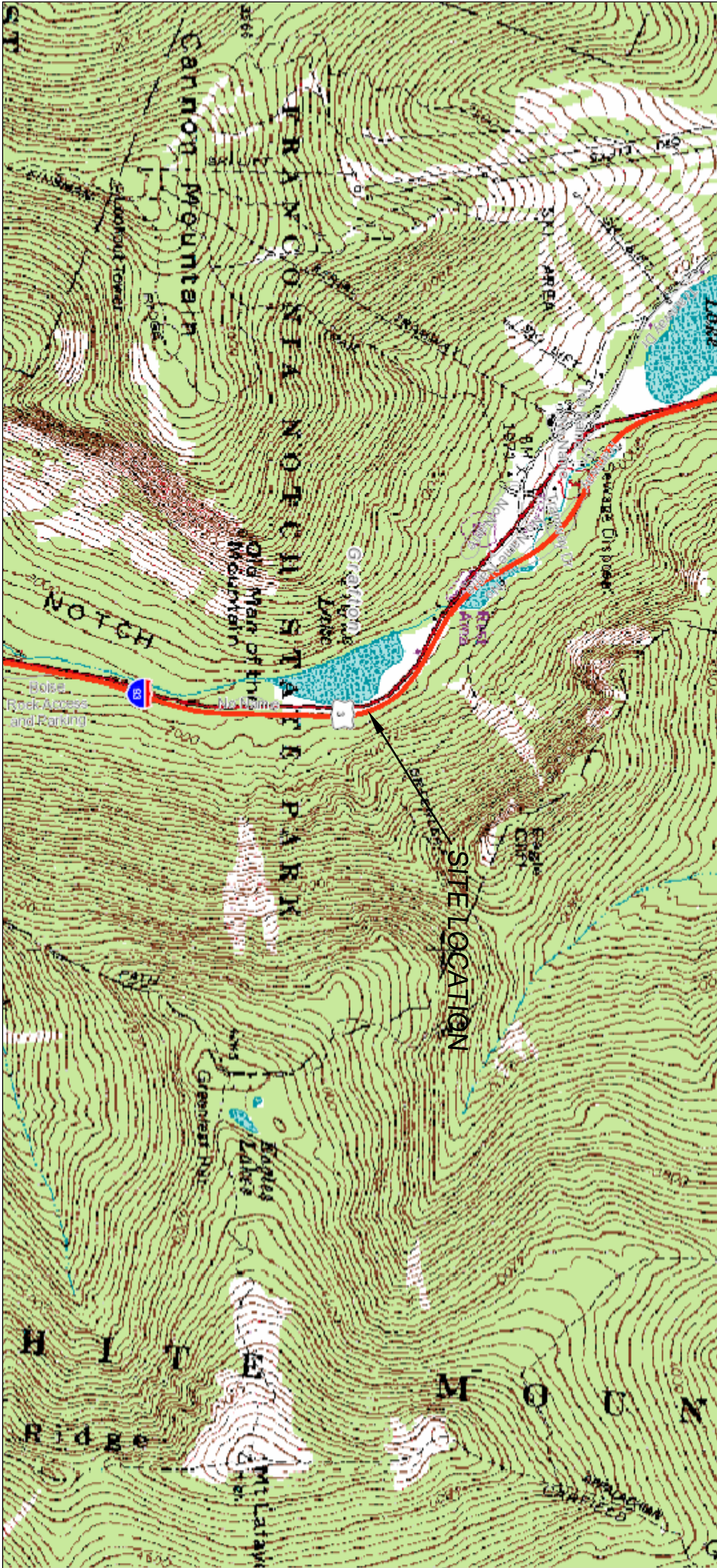

LOCUS MAP  
NOT-TO-SCALE

SHEET INDEX

Number	Sheet Name	Latest Issue
1.	Cover Sheet	5-10-18
2.	Existing Conditions	2-17-18
3.	Overall Site Plan Layout	5-10-18
4.	Site Plan Detail	5-10-18
5.	Site Plan Detail	5-10-18
6.	Site Plan Detail	5-10-18
7.	Site Plan Detail	5-10-18
8.	Construction Details	5-10-18
9.	Construction Details	2-17-18

3	5-10-18	ADDRESS NHDES COMMENTS	EMD
2	2-17-18	ADDRESS NHDES COMMENTS	EMD
1	11-17-17	ADDRESS NHDES COMMENTS	EMD
NO.	DATE	DESCRIPTION	BY



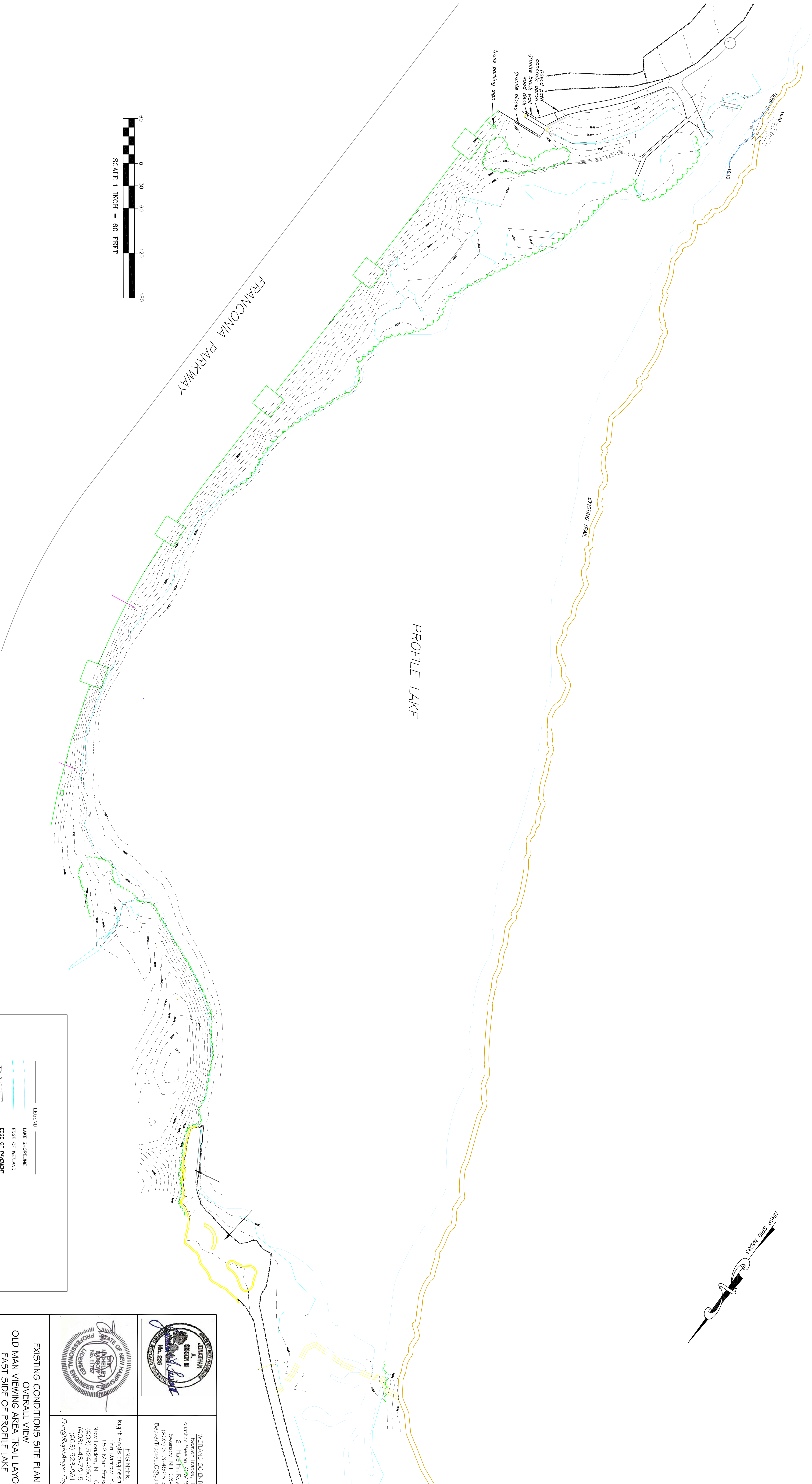

- GENERAL NOTES
1. THIS PLAN HAS BEEN PREPARED FOR REVIEW BY THE NEW HAMPSHIRE DEPARTMENT OF ENVIRONMENTAL SERVICES FOR THE DREDGE AND FILL AND SHORELAND PERMIT REVIEWS.
  2. SITE SURVEY DATA COLLECTED BY YORK LAND SURVEY IN 2016. ELEVATION DATA IS INSTRUMENT DETERMINED ON SITE AND IS BASED ON THE NAVD 88 DATUM, IN THE NH STATE PLANE COORDINATE SYSTEM (US FEET), NAD 83/86.
  3. ALL WETLANDS WERE DELINEATED IN ACCORDANCE WITH THE ARMY CORPS OF ENGINEERS METHOD FOR THE DELINEATION OF WETLANDS, JANUARY 1987, BY BEAVER TRACKS LLC, JONATHAN SISSON, C.S.S., C.W.S., IN 2016.

NO.	DATE	DESCRIPTION	BY
1			

Jonathan Sisson  
Professional Engineer  
No. 1787  
State of New Hampshire

WETLAND SCIENTIST:  
Beaver Tracks, LLC  
Jonathan Sisson, C.W.S., C.S.S.  
21 Tule Hill Road  
Salem, NH 03078  
(603) 313-4825 phone  
BeaverTracksLLC@yahoo.com

ENGINEER:  
Right Angle Engineering, PLLC  
Erin Barrow, P.E.  
152 Main Street  
New London, NH 03257  
(603) 526-2807 office  
(603) 443-7815 mobile  
(603) 523-8811 fax  
Erin@RightAngleEngineering.com

EXISTING CONDITIONS SITE PLAN  
OVERALL VIEW  
OLD MAN VIEWING AREA TRAIL LAYOUT  
EAST SIDE OF PROFILE LAKE  
FRANCONIA NOTCH  
FRANCONIA, NEW HAMPSHIRE  
FEBRUARY 6, 2017  
OWNER:  
STATE OF NEW HAMPSHIRE  
DEPARTMENT OF RESOURCES  
& ECONOMIC DEVELOPMENT  
172 FEWBROKE ROAD  
CONCORD, NH 03301  
PREPARED FOR:  
NORTHERN NEW ENGLAND FIELD SERVICES  
DENNIS THOMPSON, OWNER  
711 PIPER HILL ROAD  
STEWARTSTOWN, NH 03576





3	6-11-18	NHDES SHORELAND PERMIT RFM1	EMD
2	5-10-18	ADD LABELS FOR TOP OF BANK	EMD
1	11-17-17	REMOVE BOARDWALK; MODIFY TRAIL	EMD
		LOCATION, ADD FISHING PLATFORM	
NO.	DATE	DESCRIPTION	BY



**WETLAND SCIENTIST:**  
Beaver Tracks, LLC  
Jonathan Sisson, C.W.S., C.J.S.  
21 Hule Hill Road  
Salem, NH 03078  
BeaverTracksLLC@yahoo.com



**ENGINEER:**  
Right Angle Engineering, PLLC  
Erin Barton, P.E.  
152 Main Street  
New London, NH 03257  
(603) 526-2807 office  
(603) 443-7815 mobile  
(603) 523-8811 fax  
Erin@RightAngleEngineering.com

PROPOSED CONDITIONS SITE PLAN  
OVERALL VIEW  
OLD MAN VIEWING AREA TRAIL LAYOUT  
EAST SIDE OF PROFILE LAKE  
FRANCONIA NOTCH  
FRANCONIA, NEW HAMPSHIRE  
FEBRUARY 2, 2017

OWNER:  
STATE OF NEW HAMPSHIRE  
DEPARTMENT OF RESOURCES  
& ECONOMIC DEVELOPMENT  
172 FEWBROKE ROAD  
CONCORD, NH 03301  
PREPARED FOR:  
NORTHERN NEW ENGLAND FIELD SERVICES  
DENNIS THOMPSON, OWNER  
711 PIPER HILL ROAD  
STEWARTSTOWN, NH 03576

- GENERAL NOTES**
- THIS PLAN HAS BEEN PREPARED FOR REVIEW BY THE NEW HAMPSHIRE DEPARTMENT OF ENVIRONMENTAL SERVICES FOR THE DREDGE AND FILL AND SHORELAND PERMIT REVIEWS.
  - SITE SURVEY DATA COLLECTED BY YORK LAND SURVEY IN 2016 AND 2017. ELEVATION DATA IS INSTRUMENT DETERMINED ON SITE AND IS BASED ON THE NAVD 88 DATUM, IN THE NH STATE PLANE COORDINATE SYSTEM (US FEET), NAD 83/86.
  - ALL WETLANDS WERE DELINEATED IN ACCORDANCE WITH THE ARMY CORPS OF ENGINEERS METHOD FOR THE DELINEATION OF WETLANDS, JANUARY 1987, BY BEAVER TRACKS LLC, JONATHAN SISSON, C.S.S., C.W.S., IN 2016.

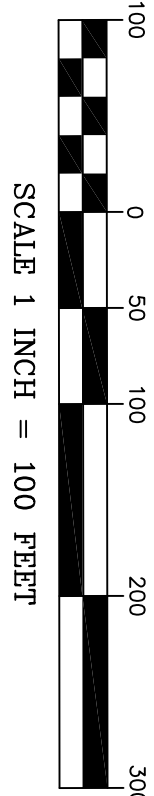



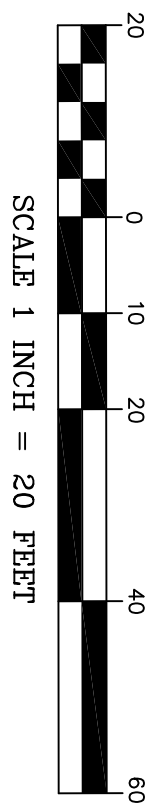
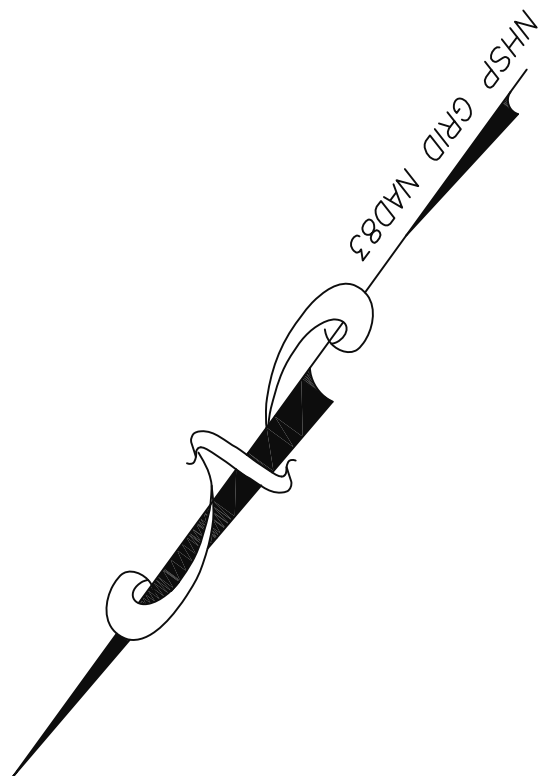
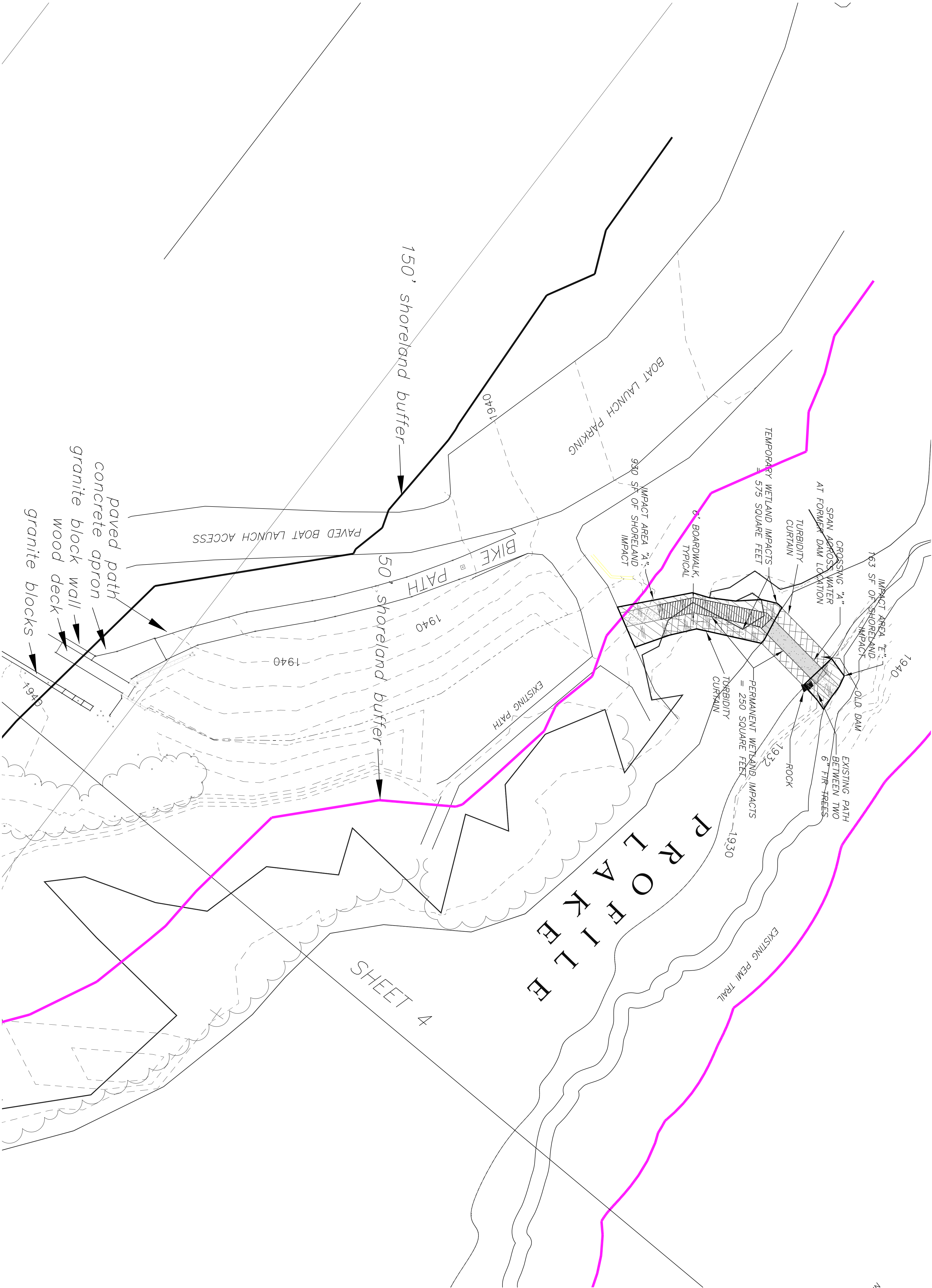

4	6-11-18	NHDES SHORELAND PERMIT RFM	EMD
3	5-10-18	ADD LABELS FOR TOP OF BANK	EMD
2	2-17-18	ADD CROSSING DETAILS	EMD
1	11-17-17	REMOVE BOARDWALK; MODIFY TRAIL LOCATION; ADD FISHING PLATFORM	EMD
NO.	DATE	DESCRIPTION	BY



WETLAND SCIENTIST:  
Beaver Tracts, LLC  
Jonathan Sisson, C.W.S., C.S.S.  
21 Hale Hill Road  
Swanzey, NH 03446  
(603) 313-4925 phone  
BeaverTractsLLC@yahoo.com

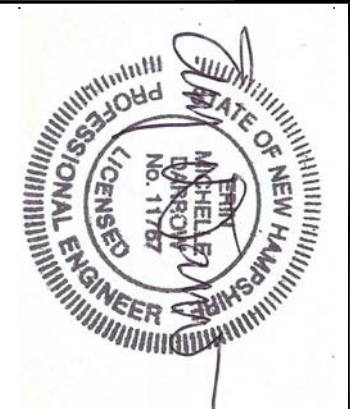

ENGINEER:  
Right Angle Engineering, PLLC  
Erin Darow, P.E.  
1152 Main Street  
New London, NH 03257  
(603) 526-2807 office  
(603) 443-7815 mobile  
(603) 525-0611 fax  
Erin@RightAngle-Engineering

PROPOSED CONDITIONS SITE PLAN  
DETAILED VIEW  
SOUTH END OF LAKE  
OLD MAN VIEWING AREA TRAIL LAYOUT  
EAST SIDE OF PROFILE LAKE  
FRANCONIA NOTCH  
FRANCONIA, NEW HAMPSHIRE  
FEBRUARY 2, 2017

OWNER:  
STATE OF NEW HAMPSHIRE  
DEPARTMENT OF RESOURCES  
& ECONOMIC DEVELOPMENT  
172 FEWBROKE ROAD  
CONCORD, NH 03301  
PREPARED FOR:  
NORTHERN NEW ENGLAND FIELD SERVICES  
DENNIS THOMPSON, OWNER  
711 PIPER HILL ROAD  
STEWARTSTOWN, NH 03576

- GENERAL NOTES
1. THIS PLAN HAS BEEN PREPARED FOR REVIEW BY THE NEW HAMPSHIRE DEPARTMENT OF ENVIRONMENTAL SERVICES FOR THE DREDGE AND FILL AND SHORELAND PERMIT REVIEWS.
  2. SITE SURVEY DATA COLLECTED BY YORK LAND SURVEY IN 2016 AND 2017. ELEVATION DATA IS INSTRUMENT DETERMINED ON SITE AND IS BASED ON THE NAVD 88 DATUM, IN THE NH STATE PLANE COORDINATE SYSTEM (US FEET), NAD 83/86.
  3. ALL WETLANDS WERE DELINEATED IN ACCORDANCE WITH THE ARMY CORPS OF ENGINEERS METHOD FOR THE DELINEATION OF WETLANDS, JANUARY 1987, BY BEAVER TRACTS LLC, JONATHAN SISSON, C.S.S., C.W.S., IN 2016.



P R O F I L E L A K E

SHEET 5

SHEET 5  
SHEET 6

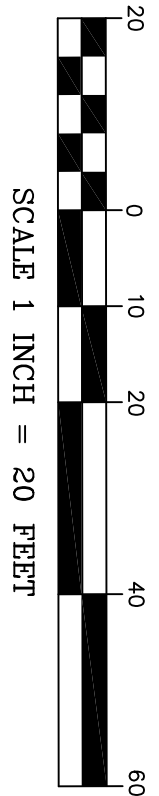
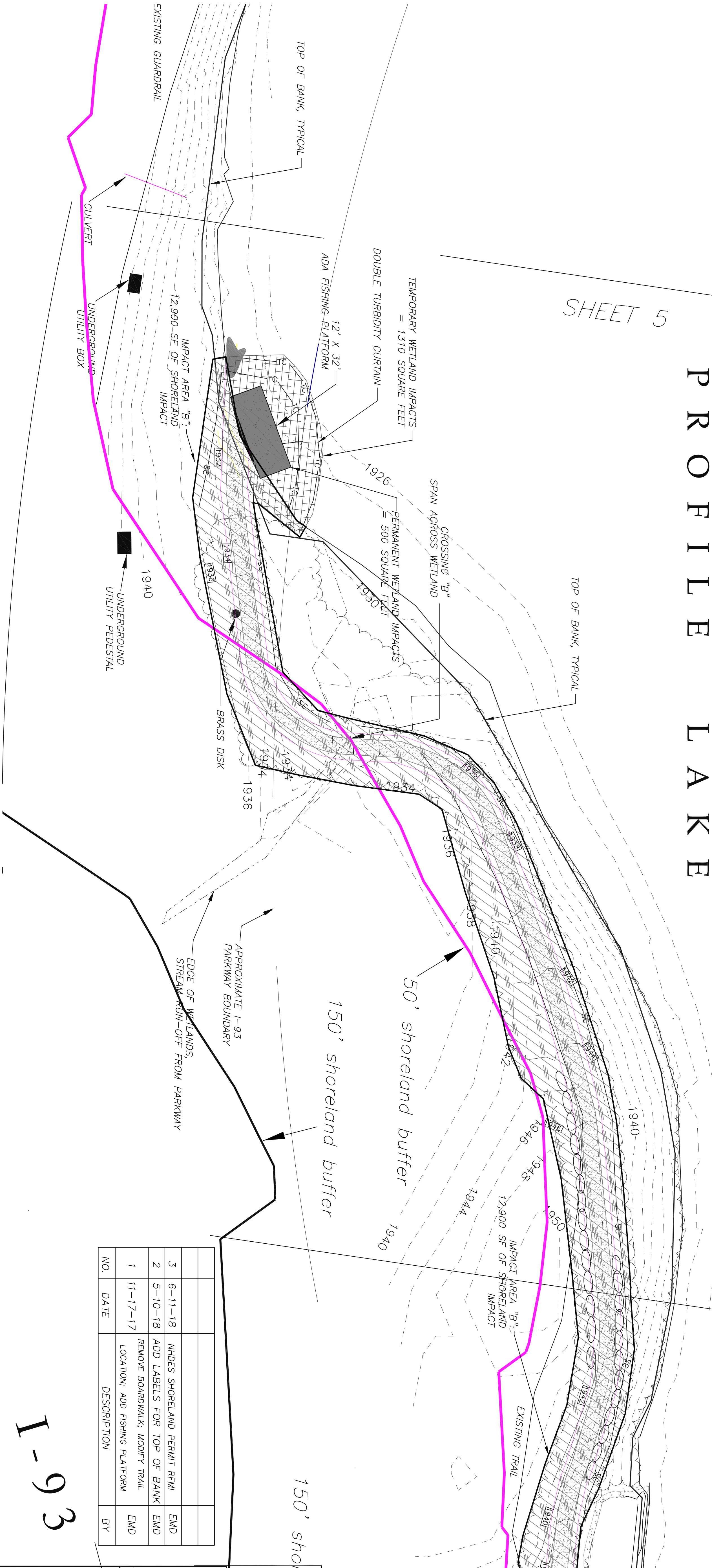
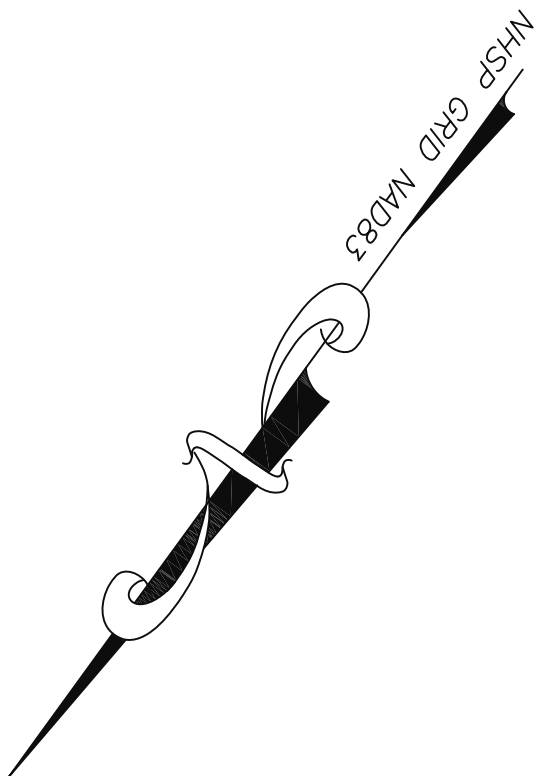

NO.	DATE	DESCRIPTION	BY
3	6-11-18	NHDES SHORELAND PERMIT RRM1	EMD
2	5-10-18	ADD LABELS FOR TOP OF BANK	EMD
1	11-17-17	REMOVE BOARDWALK, MODIFY TRAIL LOCATION, ADD FISHING PLATFORM	EMD

I-93

- GENERAL NOTES
- THIS PLAN HAS BEEN PREPARED FOR REVIEW BY THE NEW HAMPSHIRE DEPARTMENT OF ENVIRONMENTAL SERVICES FOR THE DREDGE AND FILL AND SHORELAND PERMIT REVIEWS.
  - SITE SURVEY DATA COLLECTED BY YORK LAND SURVEY IN 2016 AND 2017. ELEVATION DATA IS INSTRUMENT DETERMINED ON SITE AND IS BASED ON THE NAVD 88 DATUM, IN THE NH STATE PLANE COORDINATE SYSTEM (US FEET), NAD 83/86.
  - ALL WETLANDS WERE DELINEATED IN ACCORDANCE WITH THE ARMY CORPS OF ENGINEERS METHOD FOR THE DELINEATION OF WETLANDS, JANUARY 1987, BY BEAVER TRACKS LLC, JONATHAN SISSON, C.S.S., C.W.S., IN 2016.

WETLAND SCIENTIST:  
Beaver Tracks, LLC  
Jonathan Sisson, C.W.S., C.S.S.,  
21 Hale Hill Road  
Swanzey, NH 03446  
(603) 313-4925 phone  
beavertracksllc@yahoo.com

ENGINEER:  
Right Angle Engineering, PLLC  
Elin Darow, P.E.  
1152 Main Street  
New London, NH 03257  
(603) 526-2807 office  
(603) 443-7815 mobile  
(603) 525-0611 fax  
Em@rightangleengineering

PROPOSED CONDITIONS SITE PLAN  
DETAILED VIEW  
ADA FISHING PLATFORM ACCESS  
OLD MAN VIEWING AREA TRAIL LAYOUT  
PROFILE LAKE  
FRANCONIA NOTCH  
FRANCONIA, NEW HAMPSHIRE  
FEBRUARY 2, 2017

OWNER:  
STATE OF NEW HAMPSHIRE  
DEPARTMENT OF RESOURCES  
& ECONOMIC DEVELOPMENT  
172 FEWBROKE ROAD  
CONCORD, NH 03301

PREPARED FOR:  
NORTHERN NEW ENGLAND FIELD SERVICES  
DENNIS THOMPSON, OWNER  
711 PIPER HILL ROAD  
STEWARTSTOWN, NH 03576



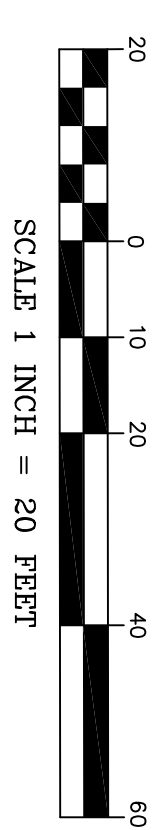

**ENGINEER:**  
Right Angle Engineering, PLLC  
Ern Barrow, P.E.  
152 Main Street  
New London, NH 03257  
(603) 526-2807 office  
(603) 443-7815 mobile  
(603) 523-0811 fax  
Ern@RightAngle.Engineering

FEBRUARY 2, 2017

OWNER:

STATE OF NEW HAMPSHIRE  
DEPARTMENT OF RESOURCE  
& ECONOMIC DEVELOPMENT  
172 PEMBROKE ROAD  
CONCORD, NH 03301

D FOR:

NORTHERN NEW ENGLAND FIELD SERVICES  
DENNIS THOMPSON, OWNER  
711 PIPER HILL ROAD  
STEWARTSTOWN, NH 03576

SHEET 6 OF 9

**GENERAL NOTES**

1. THIS PLAN HAS BEEN PREPARED FOR REVIEW BY THE NEW HAMPSHIRE DEPARTMENT OF ENVIRONMENTAL SERVICES FOR THE DREDGE AND FILL AND SHORELAND PERMIT REVIEWS
2. SITE SURVEY DATA COLLECTED BY YORK LAND SURVEY IN 2016 AND 2017. ELEVATION DATA IS INSTRUMENT DETERMINED ON SITE AND IS BASED ON THE NAVD 88 DATUM, IN THE NH STATE PLANE COORDINATE SYSTEM (US FEET). NAD 83/86.
3. ALL WETLANDS WERE Delineated IN ACCORDANCE WITH THE ARMY CORPS OF ENGINEERS METHOD FOR THE Delineation OF WETLANDS, JANUARY 1987, BY BEAVER TRACKS LLC, JONATHAN SISSON, C.E.S., C.W.S., IN 2016.



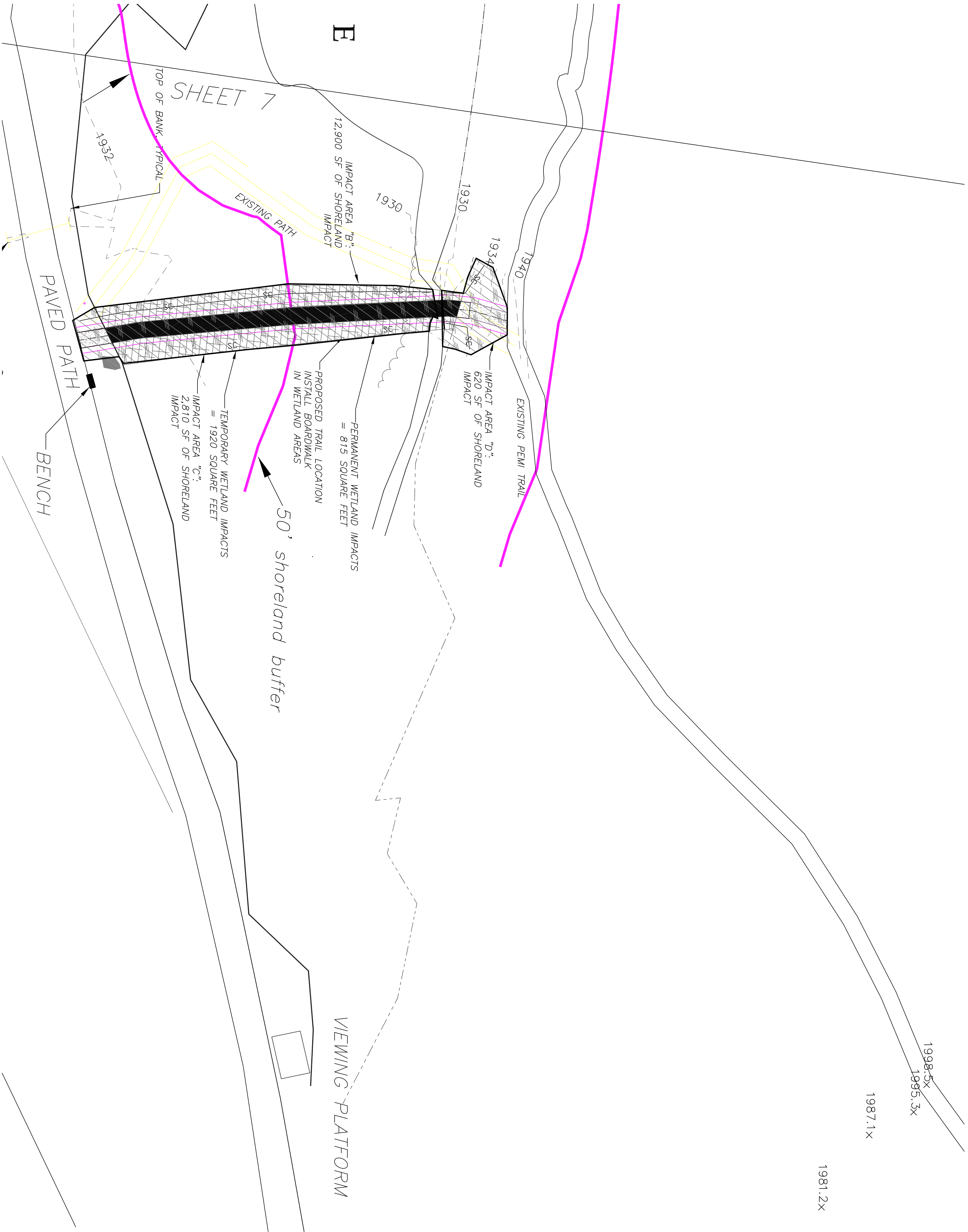
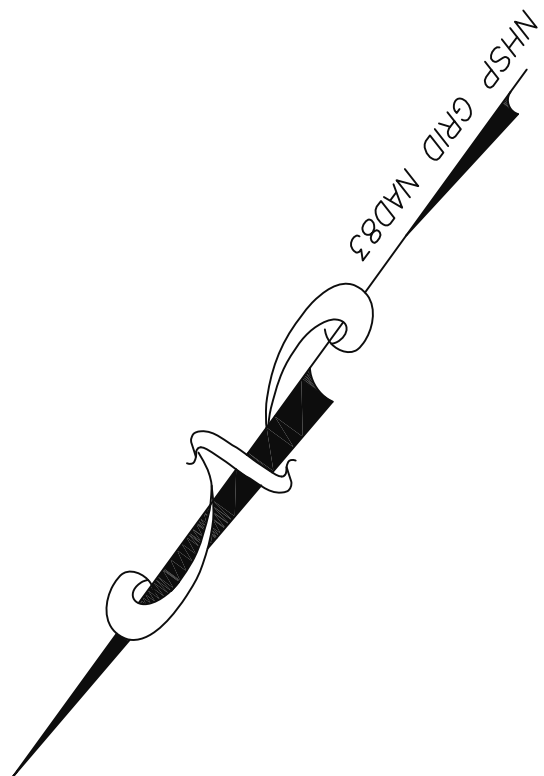

3	6-11-18	NHDES SHORELAND PERMIT RFI	EMD
2	5-10-18	ADD LABELS FOR TOP OF BANK	EMD
1	11-17-17	REMOVE BOARDWALK; MODIFY TRAIL LOCATION; ADD FISHING PLATFORM	EMD
NO.	DATE	DESCRIPTION	BY

WETLAND SCIENTIST:  
Jonathan Sisson, C.W.S., C.S.S.  
21 Hale Hill Road  
Swanzey, NH 03446  
(603) 313-4925 phone  
beavertracksllc@yahoo.com

ENGINEER:  
Erin Darow, P.E.  
152 Main Street  
New London, NH 03257  
(603) 526-2807 office  
(603) 443-7815 mobile  
(603) 525-0611 fax  
Erin@RightAngleEngineering

PROPOSED CONDITIONS SITE PLAN  
DETAILED VIEW  
NORTH END CONNECTOR TRAIL  
OLD MAN VIEWING AREA TRAIL LAYOUT  
PROFILE LAKE  
FRANCONIA NOTCH  
FRANCONIA, NEW HAMPSHIRE  
FEBRUARY 2, 2017

OWNER:  
STATE OF NEW HAMPSHIRE  
DEPARTMENT OF RESOURCES  
& ECONOMIC DEVELOPMENT  
172 FEVERBROKE ROAD  
CONCORD, NH 03301

PREPARED FOR:  
NORTHERN NEW ENGLAND FIELD SERVICES  
DENNIS THOMPSON, OWNER  
711 PIPER HILL ROAD  
STEWARTSTOWN, NH 03576

- GENERAL NOTES
- THIS PLAN HAS BEEN PREPARED FOR REVIEW BY THE NEW HAMPSHIRE DEPARTMENT OF ENVIRONMENTAL SERVICES FOR THE DREDGE AND FILL AND SHORELAND PERMIT REVIEWS.
  - SITE SURVEY DATA COLLECTED BY YORK LAND SURVEY IN 2016 AND 2017. ELEVATION DATA IS INSTRUMENT DETERMINED ON SITE AND IS BASED ON THE NAVD 88 DATUM, IN THE NH STATE PLANE COORDINATE SYSTEM (US FEET), NAD 83/86.
  - ALL WETLANDS WERE DELINEATED IN ACCORDANCE WITH THE ARMY CORPS OF ENGINEERS METHOD FOR THE DELINEATION OF WETLANDS, JANUARY 1987, BY BEAVER TRACKS LLC, JONATHAN SISSON, C.S.S., C.W.S., IN 2016.



Typical Trail Cross-Section  
Facing North  
NOT-TO-SCALE

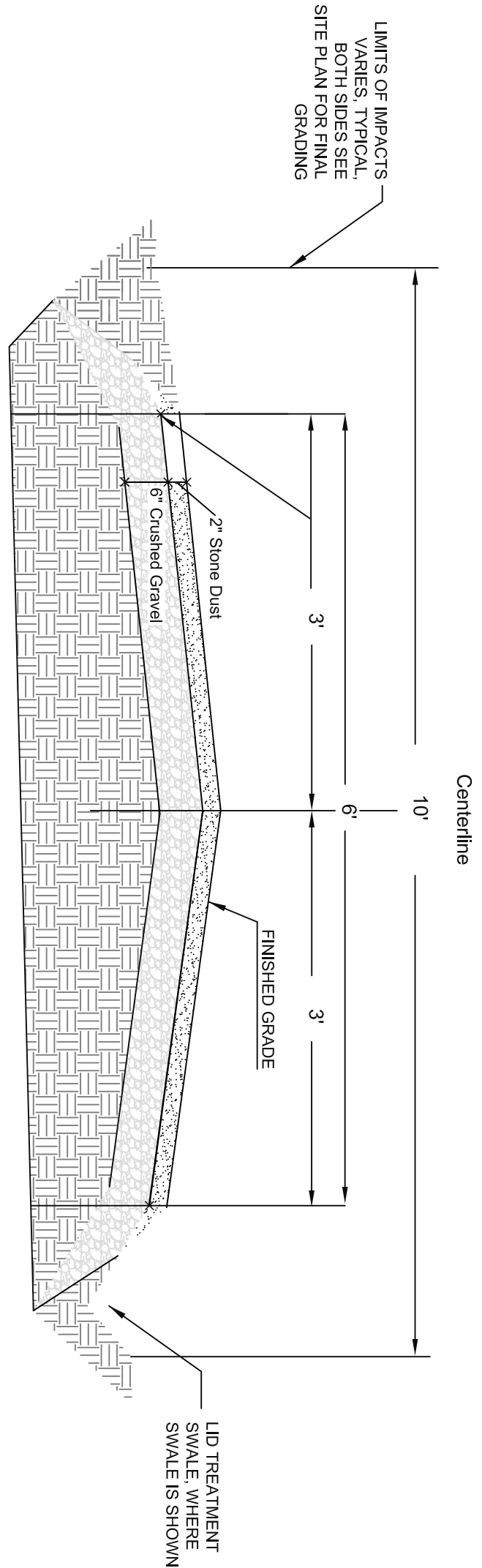

# WATER CROSSING A SOUTH END OF LAKE NOT-TO-SCALE

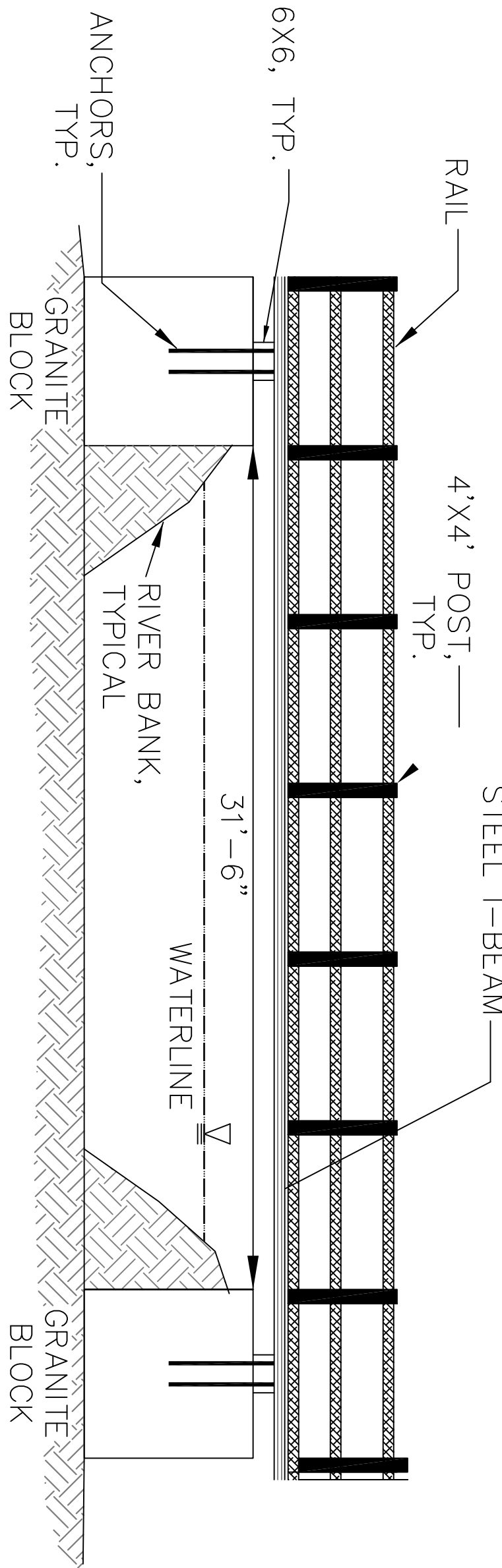

TRAIL  
BOARDWALK  
PLAN VIEW

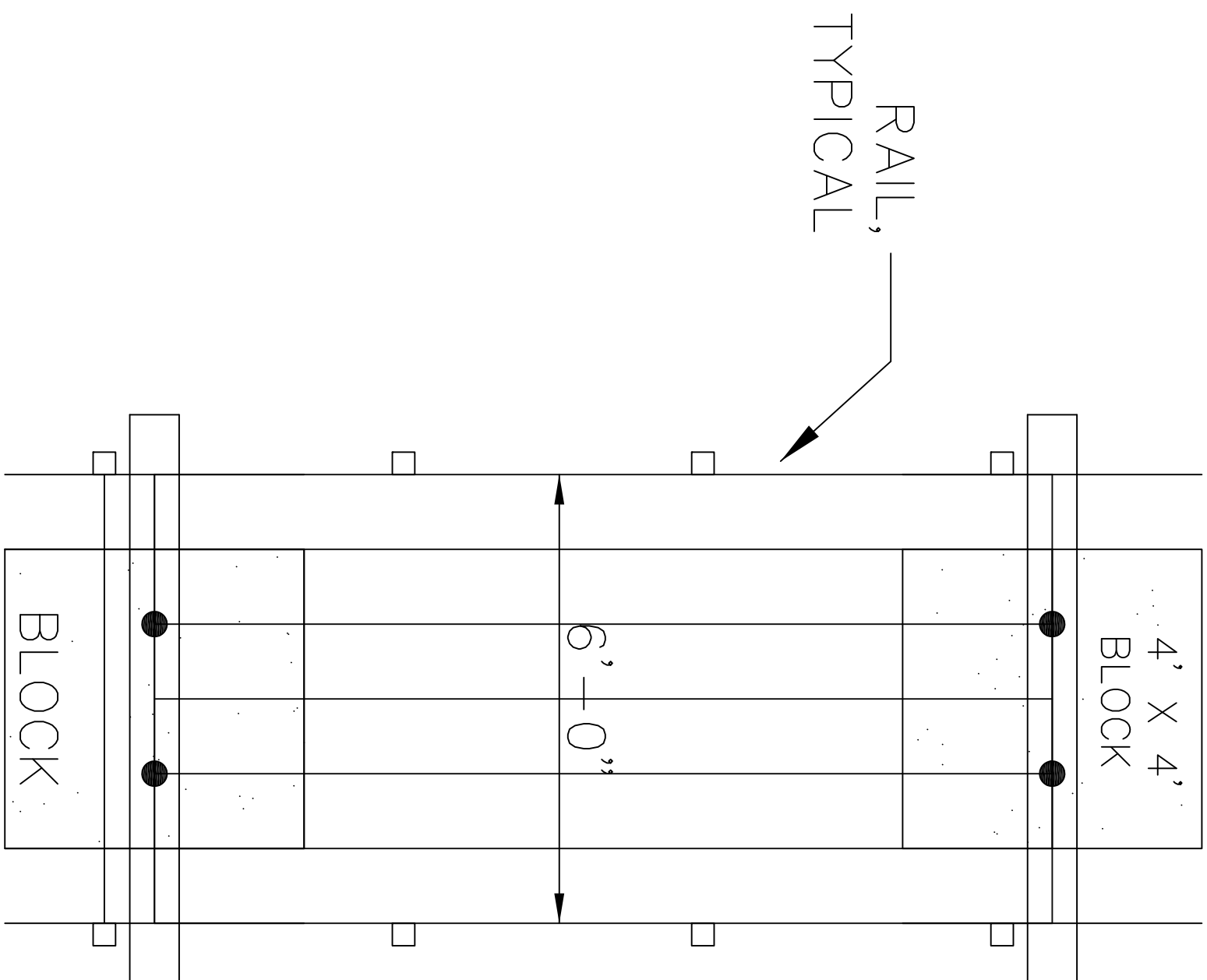

WATER CROSSING B  
STREAM AT FISHING  
PLATFORM CROSSING  
NOT-TO-SCALE

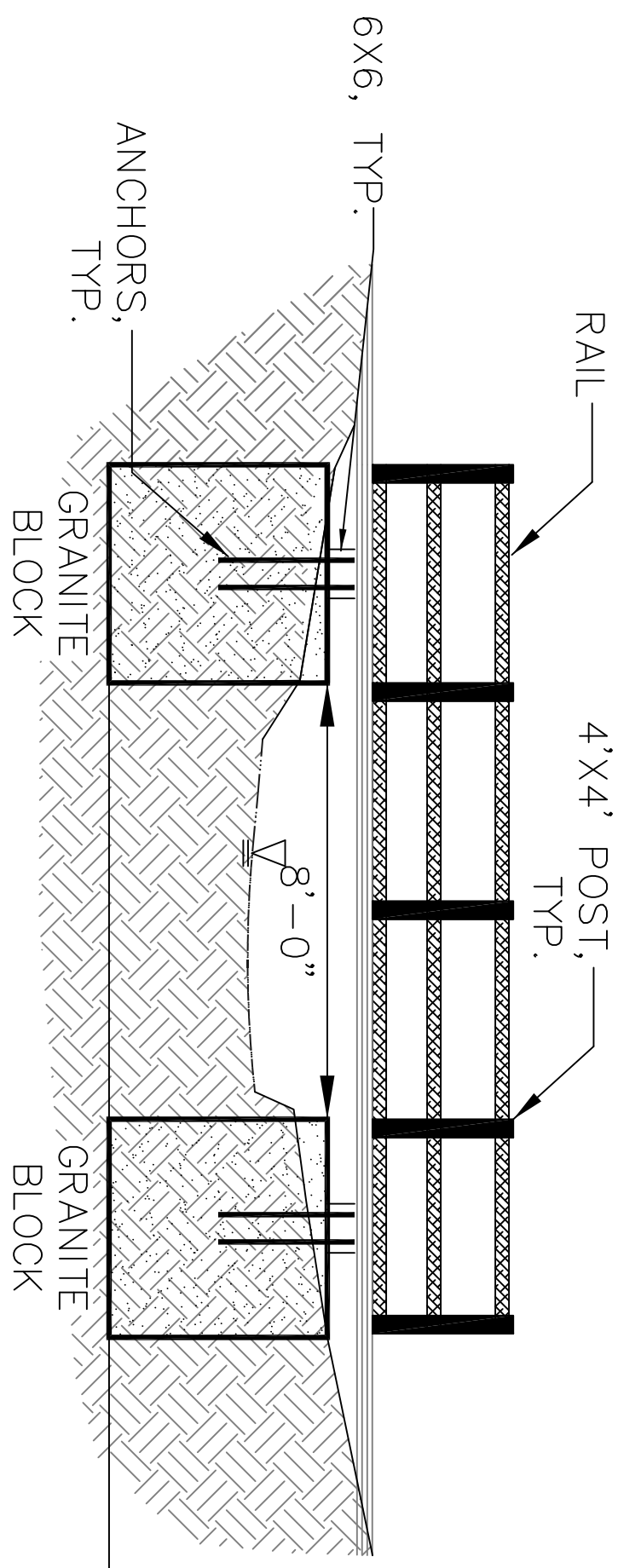

CONSTRUCTION SEQUENCE NOTES:

1. INSTALL DIMIDMENT AND EROSION CONTROL FACILITIES. ALL PERMETER CONTROLS SHALL BE INSTALLED PRIOR TO EARTH MOVING OPERATIONS.
2. ALL SEDIMENT AND EROSION CONTROL SHALL BE IN ACCORDANCE WITH NEW HAMPSHIRE DEPARTMENT OF ENVIRONMENTAL SERVICES BEST MANAGEMENT PRACTICES.
3. EITHER SILT FENCE OR SEDIMENT LOOS SHALL BE INSTALLED DOWNDRAINAGE OF ALL AREAS OF IMPACT.
4. INSPECT SITE REGULARLY TO ENSURE PROPER FUNCTION OF SEDIMENT AND EROSION CONTROLS. SITE SHALL BE INSPECTED WEEKLY, AT A MINIMUM, AND ALSO AFTER/DURING SEVERE STORM EVENTS). AFTER/DURING ANY RAINFALL THAT EXCEEDS  $\frac{1}{2}$  INCH IN 24 HOURS.
5. ALL WORK SHALL OCCUR DURING LOW-FLOW CONDITIONS, TO THE GREATEST EXTENT PRACTICABLE.
6. REMOVE BRUSH AND UNSUITABLE MATERIAL IN PROPOSED TRAIL AREA, AND DISPOSE OF IN AN APPROPRIATE OFF-SITE LOCATION.
7. INSTALL ADA FISHING PLATFORM.
8. CONSTRUCT NEW TRAIL.
9. INSTALL NEW TRAIL BOARDWALKS.
10. REMOVE SEDIMENT AND EROSION CONTROL MEASURES UPON SITE STABILIZATION.
11. CONTRACTORS IS RESPONSIBLE FOR LOCATION OF UTILITIES AND AVOIDING DAMAGE DURING CONSTRUCTION.

## AREAS OF SHORELAND IMPACTS:

1. AREA "A" = 930 SQUARE FEET
2. AREA "B" = 12,900 SQUARE FEET
3. AREA "C" = 2,810 SQUARE FEET
4. AREA "D" = 620 SQUARE FEET
5. AREA "E" = 163 SQUARE FEET
6. TOTAL AREA OF SHOULDER IMPACT = 17,423 SQUARE FEET.
7. WATERPROOF BUFFER SHALL MEET AT LEAST THE MINIMUM VEGETATIVE POINT/PERCENTAGE REQUIREMENT UPON PROJECT COMPLETION.

3	6-11-18	NHDES SHORELAND PERMIT RFM1	EMD
2	5-10-18	MODIFY CONSTRUCTION SEQUENCE	EMD
1	2-17-18	ADDRESS NHDES COMMENTS	EMD
NO.	DATE	DESCRIPTION	BY

## CONSTRUCTION DETAILS PLAN

OLD MAN VIEWING AREA  
ADA-ACCESSIBLE TRAIL  
EAST SIDE OF PROFILE LAKE  
FRANCONIA NOTCH  
FRANCONIA, NEW HAMPSHIRE

OWNER:

STATE OF NEW HAMPSHIRE  
DEPARTMENT OF CULTURAL  
NATURAL RESOURCES  
172 PEMBROKE ROAD  
CONCORD, NH 03301

PREPARED FOR:

NORTHERN NEW ENGLAND FIELD SERVICES  
DENNIS THOMPSON, OWNER  
711 PIPER HILL ROAD  
STEWARTSTOWN, NH 03576

## LEGEND

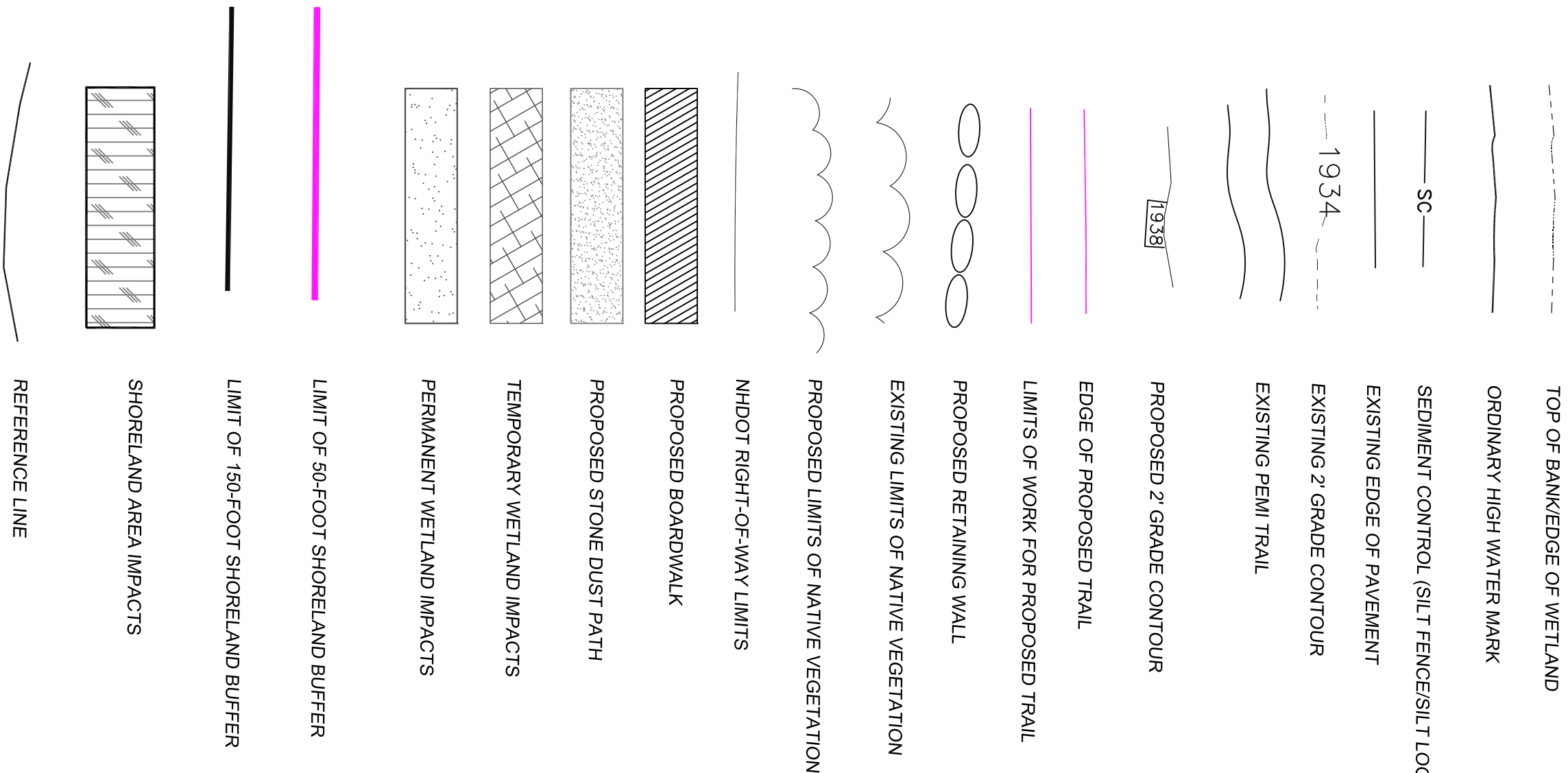

## CONSTRUCTION DETAILS PLAN



**ENGINEER:**  
Right Angle Engineering, PLLC  
Ern Darow, P.E.  
152 Main Street  
New London, NH 03257  
(603) 526-2807 office  
(603) 443-7815 mobile  
(603) 523-8811 fax  
[Ern@RightAngle.Engineering](mailto:Ern@RightAngle.Engineering)



SILT FENCE

Not to Scale

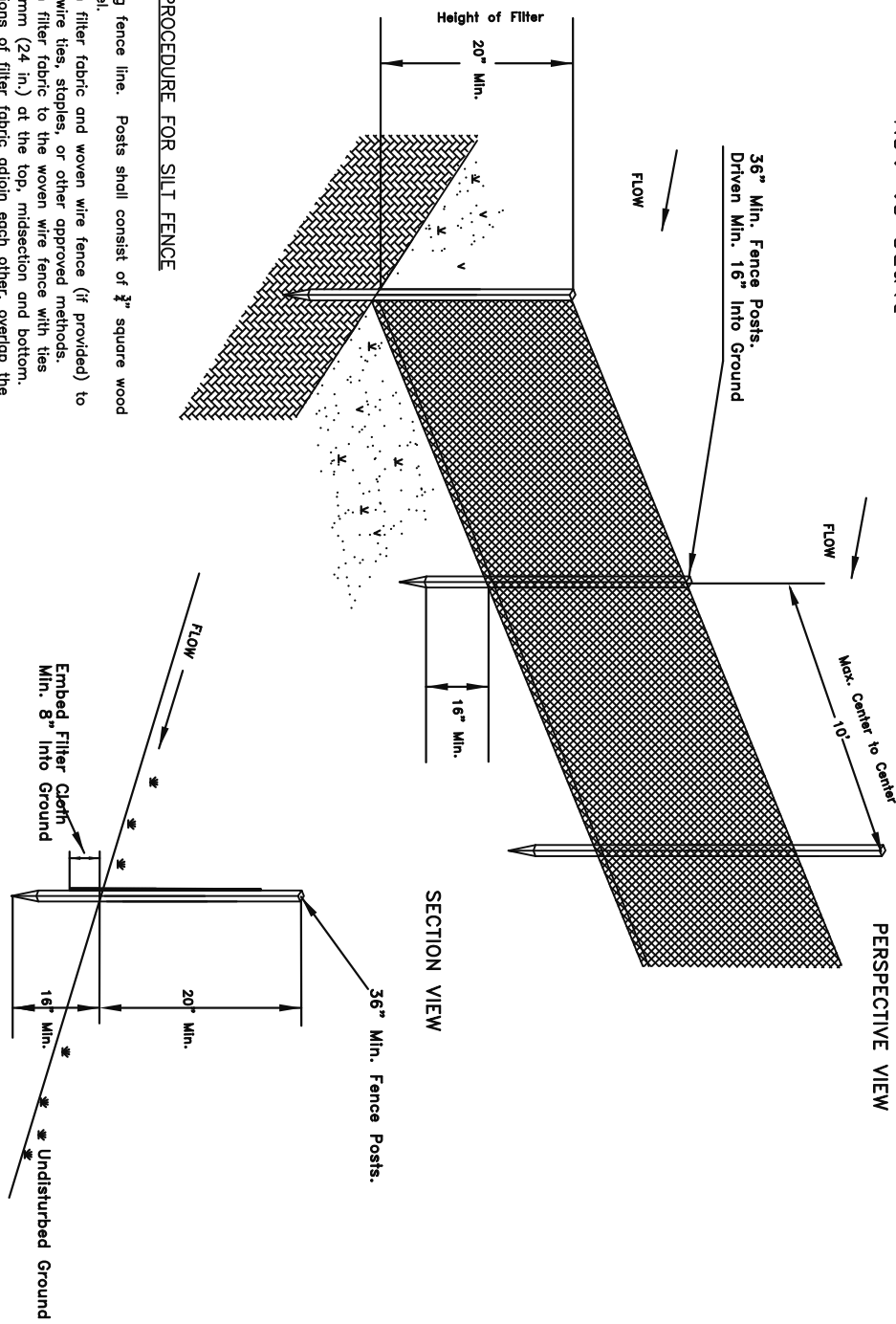

INSTALLATION PROCEDURE FOR SILT FENCE

1. Set posts using three line. Posts shall consist of 2 square wood or 1.38 inch steel.
2. Lay out filter fabric on ground. Fabric shall be 2 inches wide and 18 inches long (minimum) to 35 inches (maximum).
3. Secure fabric with two 2 inch steel stakes to the ground. The stakes shall be 18 inches apart.
4. When the section of filter fabric is in place, secure the fabric with two 2 inch steel stakes to the ground. The stakes shall be 18 inches apart.
5. The filter fabric shall be 2 inches wide and 18 inches long (minimum) to 35 inches (maximum).
6. The filter fabric shall be 2 inches wide and 18 inches long (minimum) to 35 inches (maximum).
7. The filter fabric shall be 2 inches wide and 18 inches long (minimum) to 35 inches (maximum).
8. The filter fabric shall be 2 inches wide and 18 inches long (minimum) to 35 inches (maximum).
9. The filter fabric shall be 2 inches wide and 18 inches long (minimum) to 35 inches (maximum).

HAY BALE

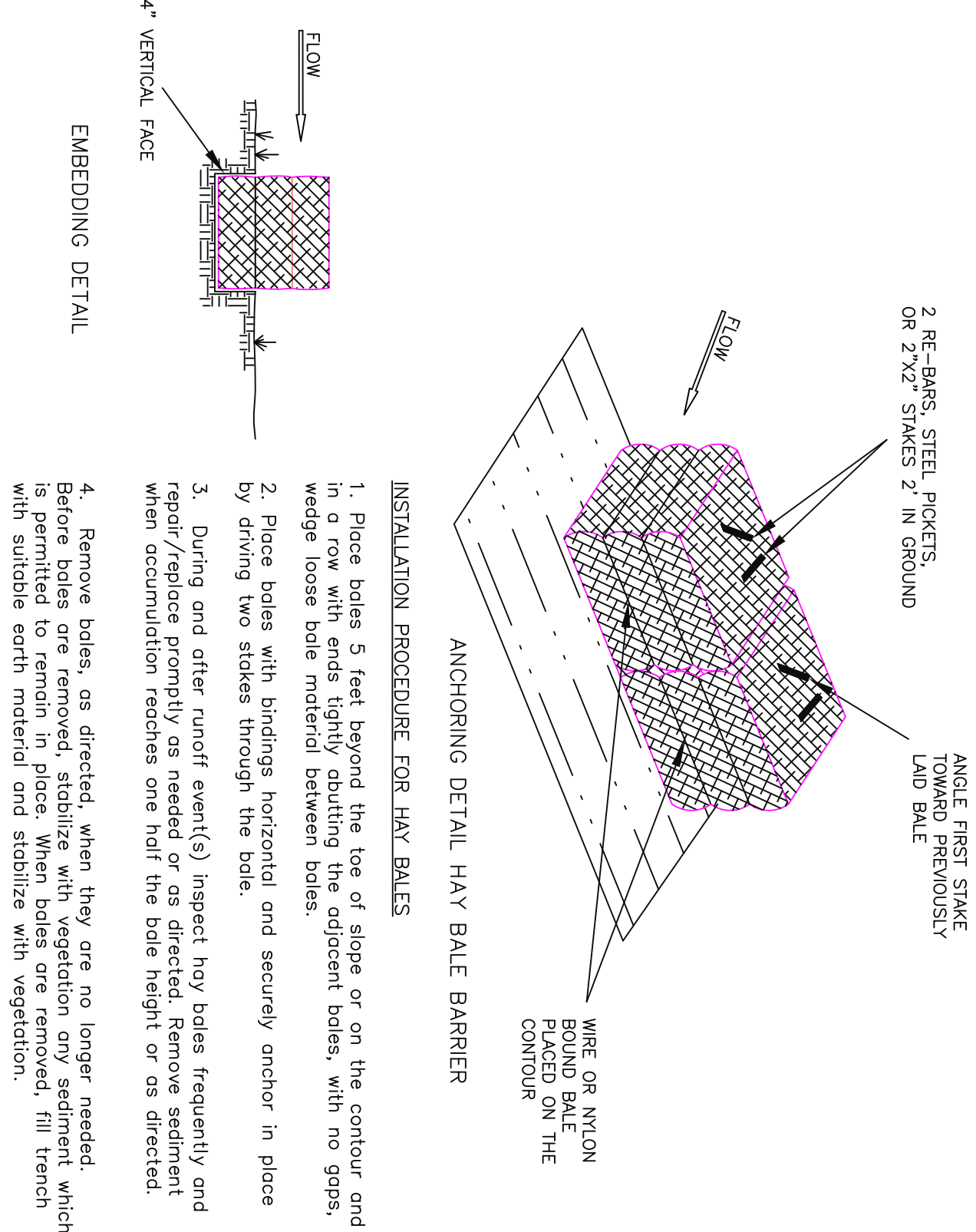

INSTALLATION PROCEDURE FOR HAY BALES

1. Place bales 5 feet beyond the toe of slope or on the contour and in a row with ends tightly abutting the adjacent bales, with no gaps, and wedge loose bale material between bales.
2. Place bales with bindings horizontal and securely anchor in place by driving two stakes through the bale.
3. During and after runoff event(s) inspect hay bales frequently and repair/replace promptly as needed or as directed. Remove sediment when accumulation reaches one half the bale height or as directed.
4. Remove bales, as directed, when they are no longer needed. Before bales are removed, stabilize with vegetation any sediment which is permitted to remain in place. When bales are removed, fill trench with suitable earth material and stabilize with vegetation.

SANDBAG BARRIER NOT-TO-SCALE

SANDBAG BARRIER NOTES:

1. Place filled sandbags tightly across stream channel to prevent the passage of water.
2. Dimensions may vary depending on locations along stream channel, and the geometry of stream at said locations.
3. Sandbag barrier shall be a minimum of three bags high.
4. The end of the barrier shall be turned up slope.
5. Sandbag rows and layers shall be staggered to eliminate gaps.

SEDIMENT LOG BARRIER

NOT-TO-SCALE

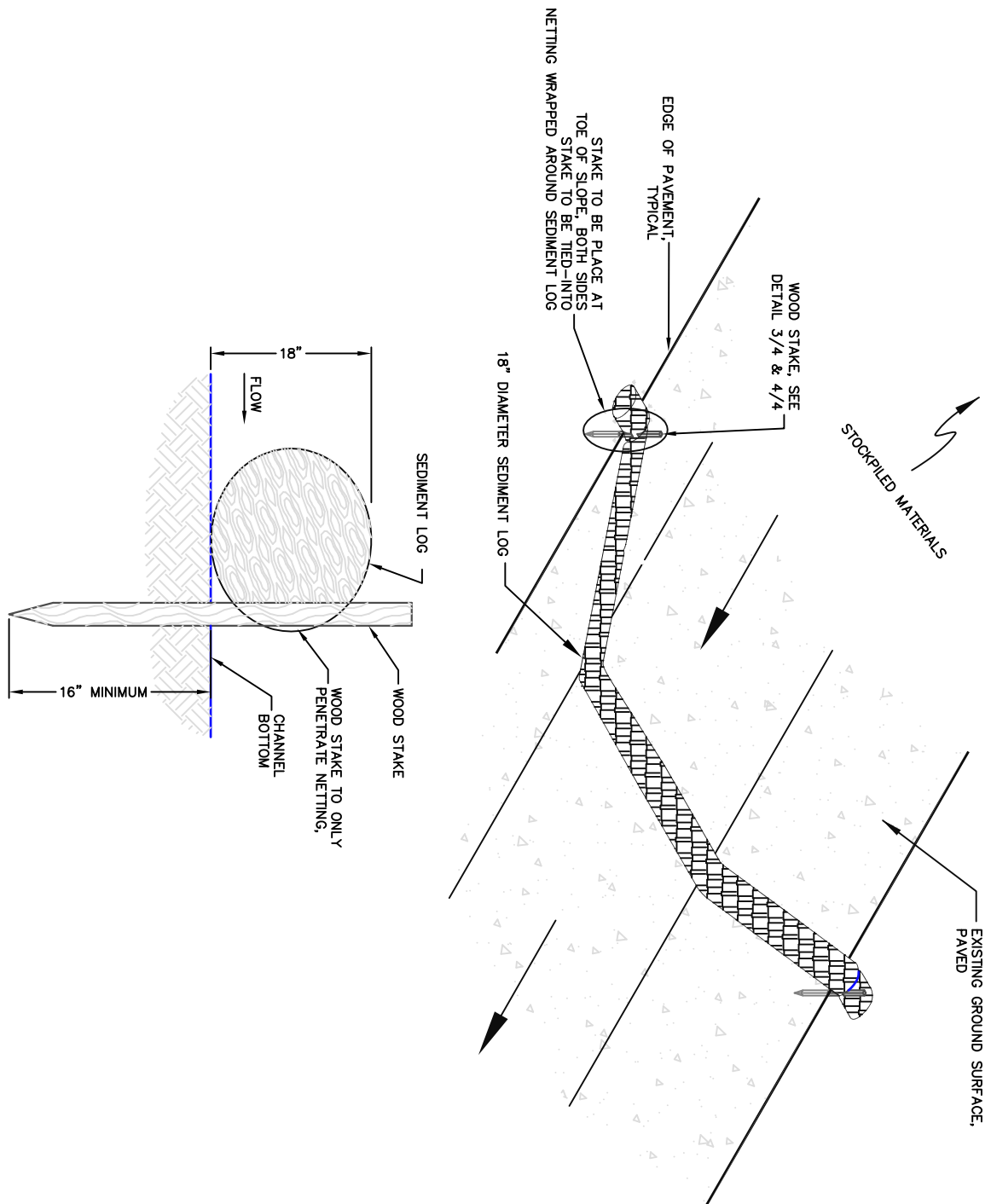

FLOATING TURBIDITY CURTAIN

NOT-TO-SCALE

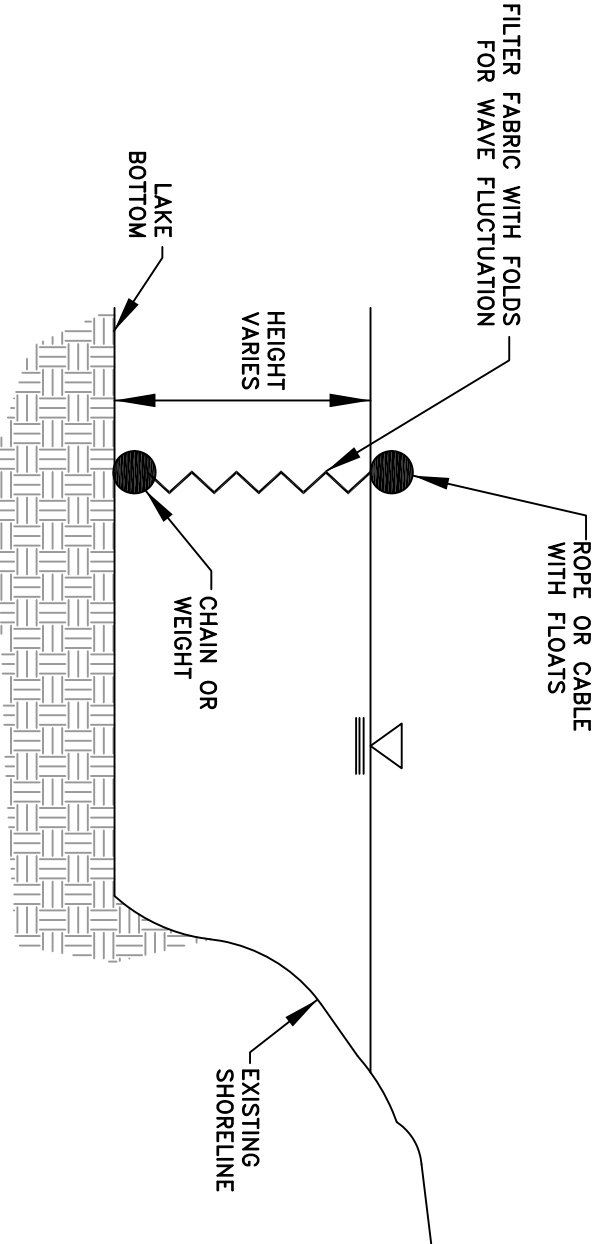

- NOTES:
1. TURBIDITY CURTAIN SHALL BE LOCATED BEYOND THE LATERAL LIMITS OF THE CONSTRUCTION SITE AND FIRMLY ANCHORED IN PLACE.
  2. HEIGHT OF THE CURTAIN SHALL BE 20 PERCENT GREATER THAN THE DEPTH OF THE WATER.
  3. AREA OF INSTALLATION SHALL BE INSPECTED FOR OBSTACLES AND IMPEDIMENTS. CURTAIN AREA SHALL BE CAREFULLY MONITORED AND HANDLED TO ENSURE THAT MATERIALS WITHIN THE SITE AREA REMAIN CONTAINED.
  4. SUPPLEMENTAL ANCHORS OF THE TURBIDITY CURTAIN ARE SHALL BE USED AS NECESSARY, DEPENDING ON WATER SURFACE DISTURBANCES SUCH AS BOATS AND WIND.
  5. TURBIDITY CURTAIN SHALL BE INSPECTED DAILY AND REPAIRED OR REPAIRED BY HAND PRIOR TO REMOVAL OF BARRIER.
  6. CONSTRUCTION SITE TO BE MAINTAINED TO PREVENT THE RELEASE OF ATTACHED SEDIMENT.
  7. ANY FLOATING CONSTRUCTION OR NATURAL DEBRIS SHALL BE REMOVED TO PREVENT DAMAGE TO THE CURTAIN.

FISH RAMP NORTH END OF LAKE NOT-TO-SCALE

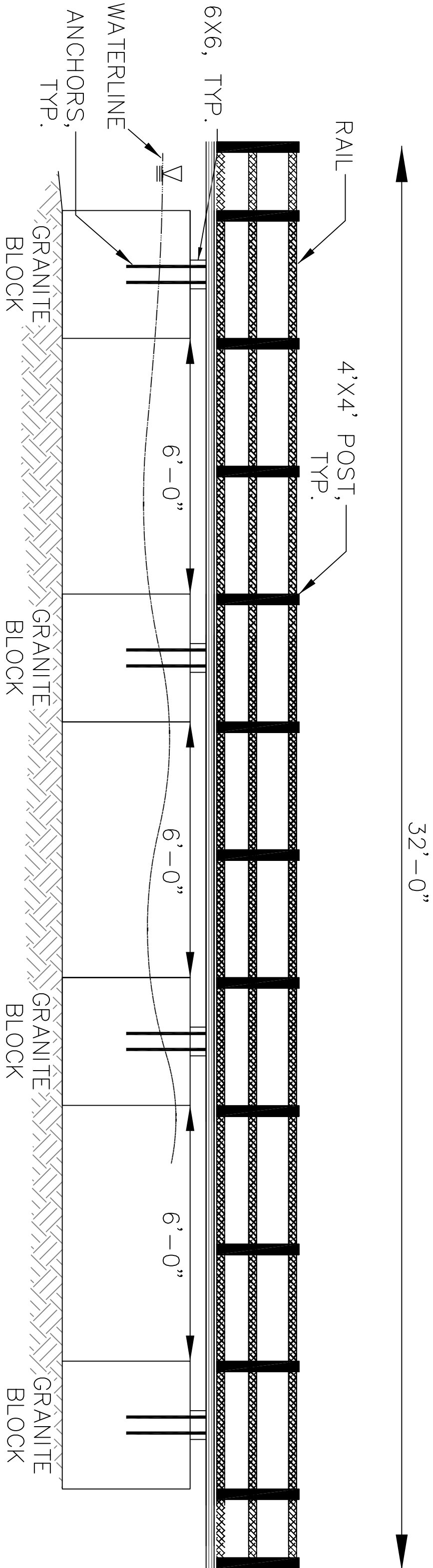

NO.	DATE	DESCRIPTION	BY
1	2-17-18	PROJECT SCOPE MODIFICATIONS	EMD
2			

ROBERT ANGLE  
PROFESSIONAL ENGINEER  
LICENSE NO. 1707  
STATE OF NEW HAMPSHIRE

ENGINEER:  
Robert Angle Engineering, PLLC  
Erin Darrow, P.E.  
152 Main Street  
New London, NH 03257  
(603) 526-2807 office  
(603) 443-7815 mobile  
(603) 523-5811 fax  
Erin@RobertAngleEngineering.com

CONSTRUCTION DETAILS PLAN

OLD MAN VIEWING AREA  
ADA-ACCESSIBLE TRAIL  
EAST SIDE OF PROFILE LAKE  
FRANCONIA NOTCH  
FRANCONIA, NEW HAMPSHIRE

OWNER:  
STATE OF NEW HAMPSHIRE  
DEPARTMENT OF RESOURCES  
& ECONOMIC DEVELOPMENT  
172 FENBROKE ROAD  
CONCORD, NH 03301

PREPARED FOR:  
NORTHERN NEW ENGLAND FIELD SERVICES  
DENNIS THOMPSON, OWNER  
711 PIER HILL ROAD  
STEWARTSTOWN, NH 03576

SHEET 9 OF 9