

**State of New Hampshire**  
**DEPARTMENT OF NATURAL AND CULTURAL RESOURCES**  
**DIVISION OF PARKS & RECREATION**  
**REQUEST FOR BID**  
**Phase IB: Archaeological Sensitivity Assessment**  
**Molligewock State Park**  
**Errol, NH**

**OBJECTIVE AND SCOPE OF WORK**

The State of New Hampshire, Department of Natural and Cultural Resources, Division of Parks and Recreation is soliciting bids from qualified parties to prepare a Phase IB Archaeological Assessment for a section of Molligewock State Park measuring approximately .10 acres. Consultants shall be 36 CFR Part 61 qualified.

The Division of Parks and Recreation is in the planning stages to construct a new visitor services building. An archaeological research project was carried out in the southernmost portion of the park by the New Hampshire State Conservation and Rescue Archaeology Program (SCRAP) in the fall of 2020. The research project resulted in the identification of a subsurface Native American archaeological site. Subsequently, a Phase IA archaeological reconnaissance survey covering the entirety of the park was carried out in the summer of 2022 and a follow up Phase 1B survey was completed in December 2022. The area to be studied was included in the Phase 1A but not the 1B.

The survey and reporting shall be completed by **September 30, 2023**.

The consultant shall:

1. Review existing documents at the Divisions of Parks and Recreation and Historical Resources.
2. Conduct Phase IB archaeological subsurface testing of the area in accordance with the Division of Historical Resources' Standards and Guideline for Archaeological Investigations in New Hampshire (2018). The existing buildings will remain, and the survey grid would be laid out to take best advantage of the area for testing. Consultant will be required to contact dig safe.
3. Provide the Division of Parks and Recreation with a Phase IB report prepared in accordance with the guidance of the NH Division of Historical Resources.
4. Provide two print copies with original photographs and one electronic copy of the final report.

The State shall:

1. Flag the area for dig safe to mark the utilities.

**BID INSTRUCTIONS**

Bids will be accepted until 3:00 pm on Wednesday June 28, 2023.

Email: [Johanna.Lyons@dncr.nh.gov](mailto:Johanna.Lyons@dncr.nh.gov)

The following information shall be included in each proposal:

1. Cover letter signed by the person submitting the proposal that summarizes the terms of the bid and commits to providing well-documented invoices in a timely manner; and
2. A not to exceed bid for the work outlined.

**AWARDING OF CONTRACT**

The contractor is expected to be able to adhere to the conditions outlined in the [State of New Hampshire P-37 Contract Agreement](#).



**PLAN REFERENCES:**

1. "BOUNDARY PLAN OF WILLOWWOOD STATE PARK," DATED FEBRUARY 16, 2018, BY STATE OF NEW HAMPSHIRE DEPT. OF RECREATION & CULTURAL RESOURCES

**NOTES:**

1. NORTH IS NEW HAMPSHIRE STATE PLANE GRID NAD83 (EPSG 5000) POSITION OF A SURVEY CONTROL POINT ESTABLISHED AS PART OF THIS PROJECT. VERTICAL DATUM IS NAD83 (EPSG)
2. WETLANDS WERE DELINEATED BY GUY COOPER, WMS #718, AND LOCATED BY THIS OFFICE ON OCTOBER 31, 2019.
3. THE PURPOSE OF THIS SKETCH IS TO DETERMINE A SUITABLE LOCATION FOR AN UPGRADE TO THE OFFICE/LABOR QUARTERS SEWER SYSTEM.

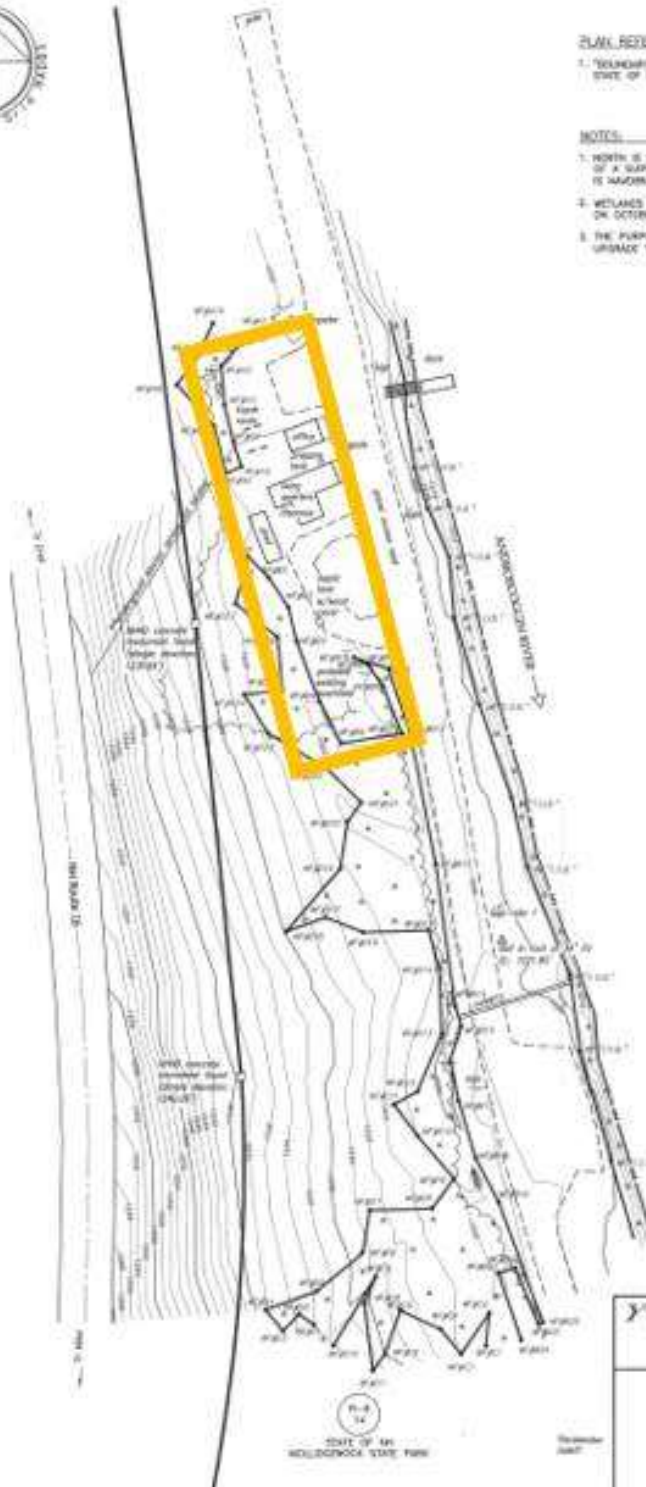

\*\*\* LEGEND \*\*\*

	Main Drive
	Detached Material
	Utility Pole, Light Pole, Detached Utility Pole
	Building
	Wetland
	Spot Elevation
	Survey Point

**YORK LAND SERVICES, LLC**  
 Riverside Courtyards, 3 Twelfth Street  
 Berlin, New Hampshire 03570 - (603)752-7282

Sketch of  
 Existing Site Conditions Near Office  
**Mollisgewock State Park**  
 Prepared for  
**NORTHERN NEW ENGLAND FIELD SERVICES**  
 Tax Map R-6 Lot 14  
 Route 16  
 Errol, New Hampshire



Scale 1" = 40.00'	Drawn by BUT, BUS	Checked by BUT
Method GPS/PP & RTK/TOTAL STATION	Date NOVEMBER 9, 2019	Drawing No. 19-100





1985

Imagery Date: 9/17/2013