

# METAL ROOF REPLACEMENT NORTH COUNTRY RESOURCES CENTER LANCASTER, NH

- NOTES:
1. STRIP AND REMOVE ALL ROOFING MATERIALS.
  2. INSPECT AND REPAIR WOOD PURLINS.
  3. INSTALL RTD SHEATHING IN AREAS INDICATED.
  4. INSTALL HI-TEMP METAL ROOF UNDERLAYMENT OVER SHEATHING.
  5. INSTALL LIGHT TRANSMITTING PANELS IN AREAS INDICATED.
  6. INSPECT & REPAIR CHIMNEY IF NECESSARY.
  7. INSTALL NEW METAL ROOF PANELS.

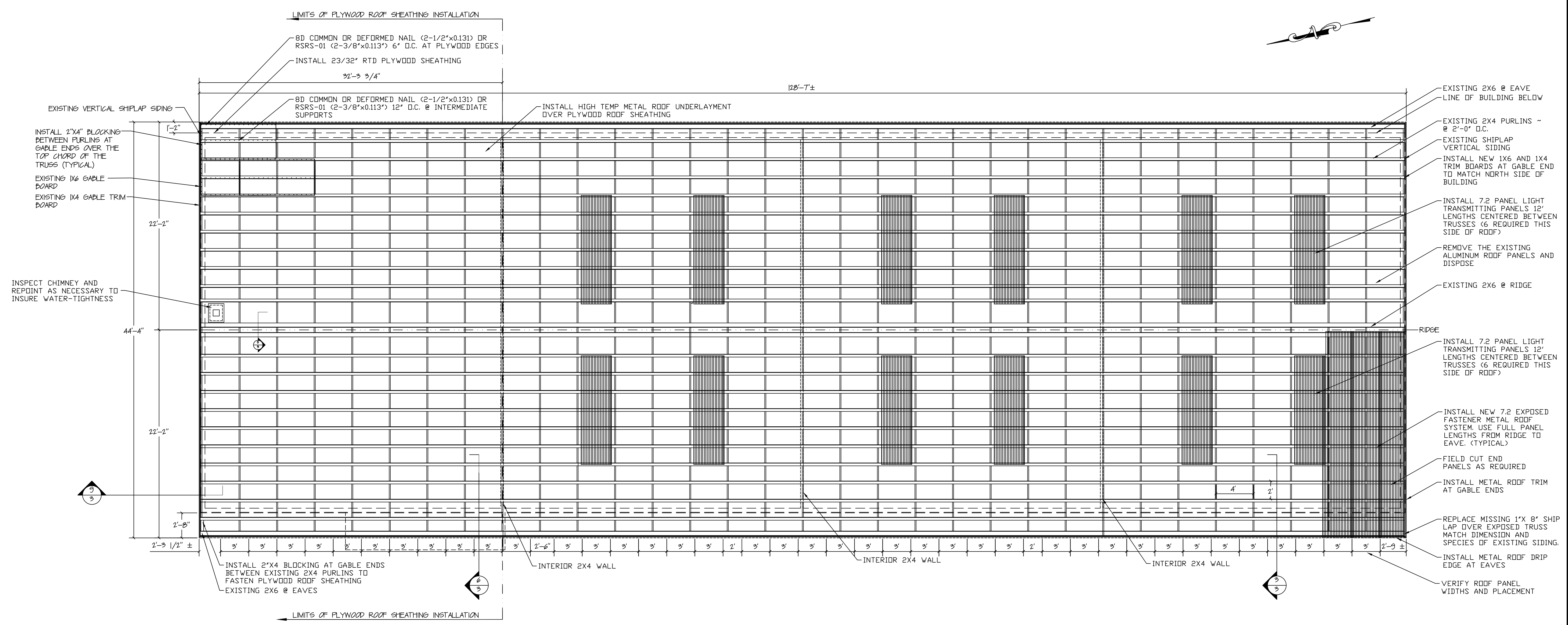

1 NHQ02 POLE BARN ROOF PLAN  
3/16" = 1'-0"

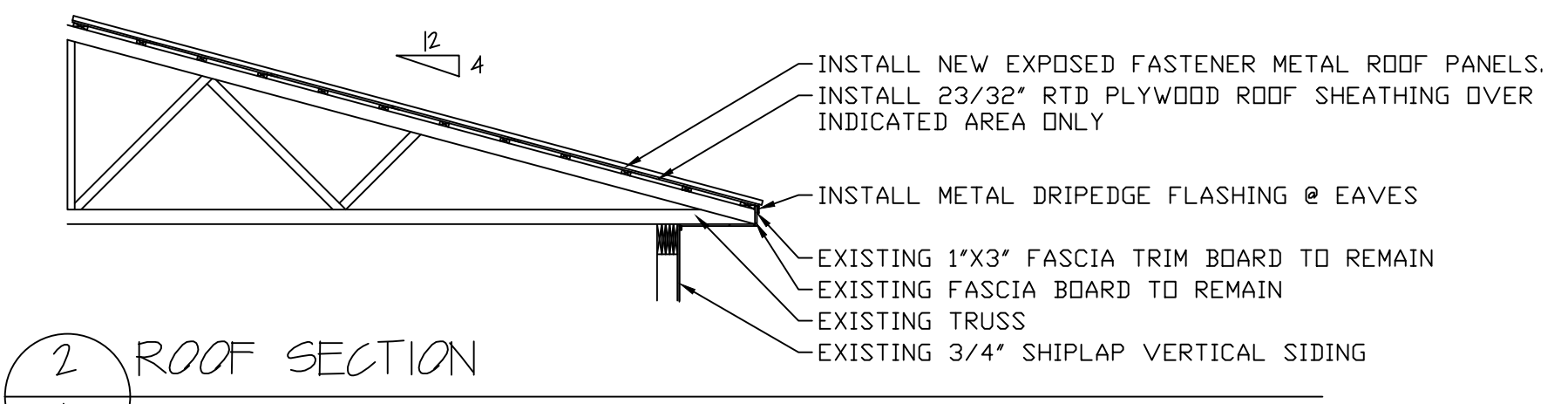

2 ROOF SECTION  
1 NOT TO SCALE

METAL ROOF REPLACEMENT POLE BARN NHQ02	DATE: JAN 27, 2023
	PROJECT # CAP-221B SCALE 3/16" = 1'-0"
APPROVED BY:	DRAWN BY: ED MUSSEY



STATE OF NEW HAMPSHIRE  
DEPARTMENT OF NATURAL AND CULTURAL RESOURCES  
PLANNING AND DEVELOPMENT SECTION  
NORTH COUNTRY RESOURCES CENTER  
LANCASTER, NEW HAMPSHIRE