

Overall Plan

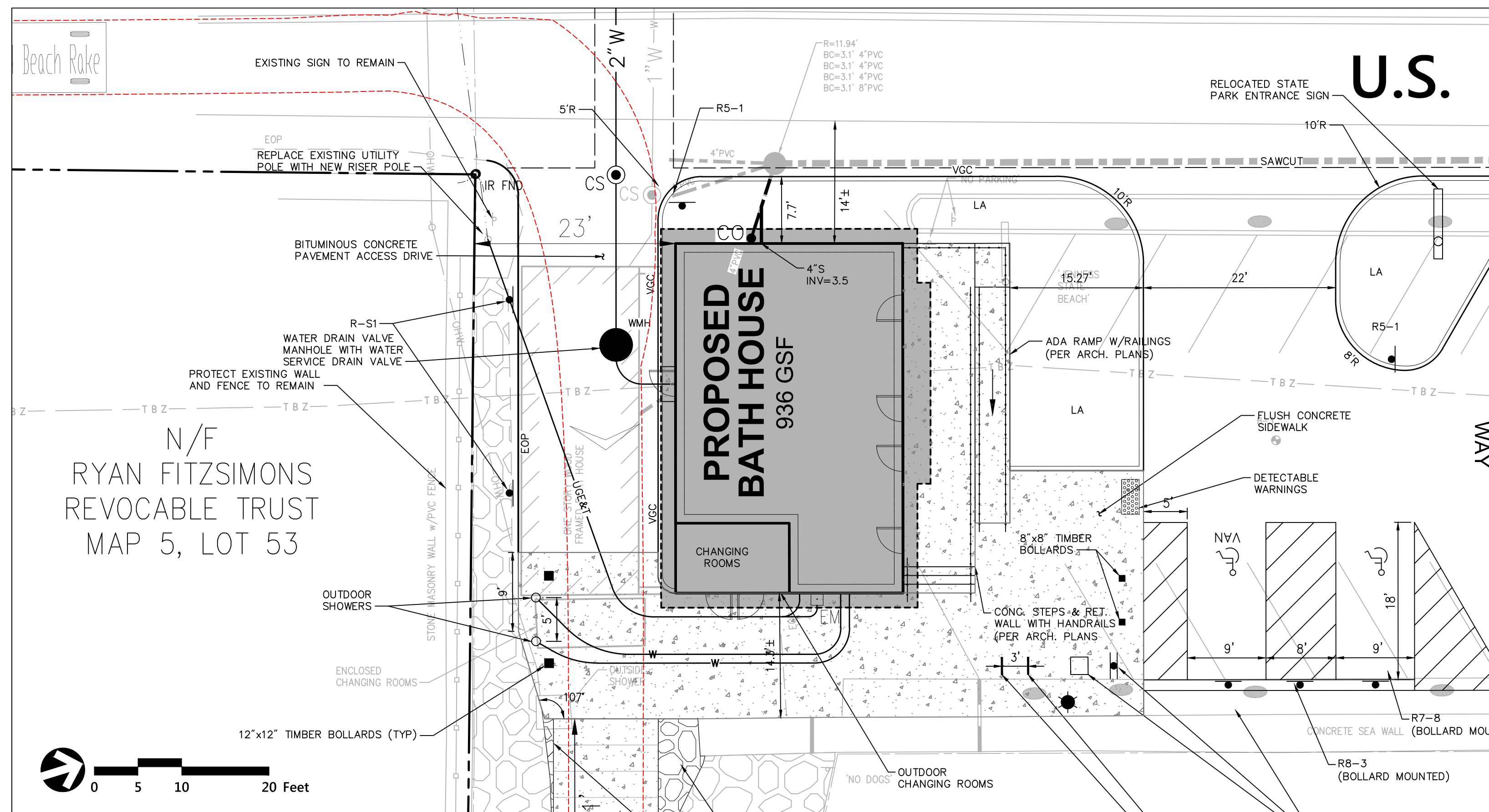

Enlargement Plan



Owner
Division of Parks and Recreation
 New Hampshire
 Department of Resources and Economic Development

Administrator
Division of Public Works, Design and Construction
 New Hampshire
 Department of Administrative Services

Civil Engineer / Landscape Architect / Surveyor



2 Bedford Farms Drive
 Suite 200
 Bedford, NH 03110
 603.391.3900
 Architect
SAMYN - D'ELIA ARCHITECTS, P.A.
 20 Main Street, Ashland, NH 03217
 (603) 968-7133 / fax: (603) 968-3057
 sdarchitects.com

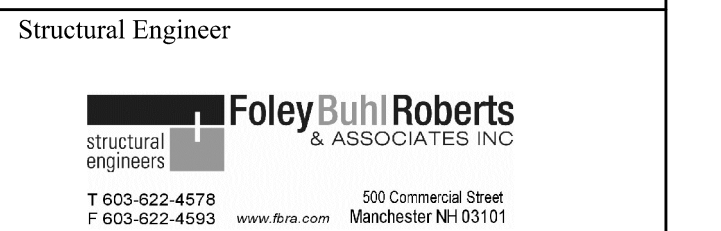

Mechanical, Electrical & Plumbing Engineer

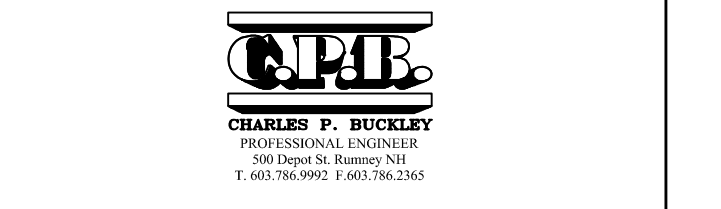

Drawing Set Log

| No. | Revision | Date | Appvd. |
|-----|----------|------|--------|
| | | | |
| | | | |
| | | | |
| | | | |
| | | | |
| | | | |
| | | | |
| | | | |
| | | | |
| | | | |

Designed by MJV / Drawn by MJV / Checked by MJV
 CAD checked by MJV / Approved by MJV

Scale: As Shown

Project Title and Location

Jenness Bathhouse Replacement and Parking Lot Improvements
 2280 Ocean Boulevard
 Rye, New Hampshire 03870

Issued for

Permitting
 ISSUED: August 11, 2017
 Not for Construction

Project Number: NHPBW - 80877B
 VHB - 52348.05
 Stamp: Progress Print For Review Only 8/04/2017

Drawing Title
Layout, Materials and Utility Plan

Drawing Number
C - 2